

RoHS

NOTES: INTERFACE CONFORMS TO MIL-STD-348, SERIES SMP
MATERIALS:

- 1. BODY CONTACT, RING BERYLLIUM COPPER PER ASTM-B-196
- 2. INSULATOR TEFLON PER ASTM-D-1710
- 3. CAP BRASS PER ASTM-B-16

FINISHES:
1. ALL METAL PARTS GOLD PLATE PER MIL-G-45204

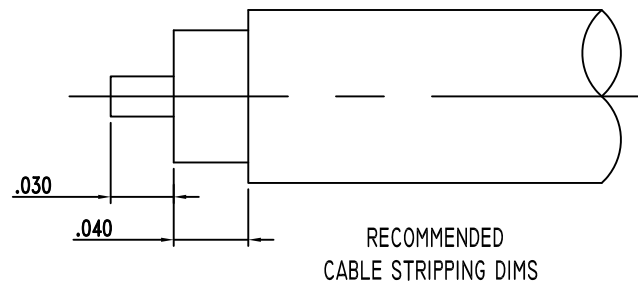
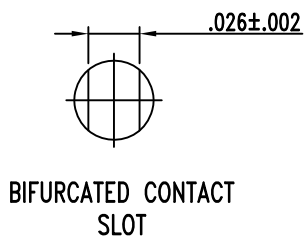

PROPRIETARY NOTICE

THIS DRAWING AND DESIGNS AND IDEAS EMBEDDED HEREIN ARE THE PROPERTY OF EZ FORM COMPANY AND WILL BE KEPT CONFIDENTIAL AND NOT BE REPRODUCED OR DISCLOSED TO ANYONE IN ANY MANNER WITHOUT THE WRITTEN CONSENT OF AN EZ FORM COMPANY OFFICIAL

REV.	REVISIONS	
	DESCRIPTION	DATE
A	ECN#9999 ADDED TOLERANCE TO .252, .187 DIMS. ADDED .102 ±.002 DIMENSION	1/30/13
B	ECN#9999 REMOVED REFERENCES; ADDED TOLERANCES FOR DIMENSIONS; ADDED REFERENCE PLANE & INTERFACE NOTE	1/30/13

UNLESS OTHERWISE SPECIFIED:

DIMENSIONS ARE IN INCHES:		SCALE	
TOLERANCES:		—	
DECIMALS:	FRACTIONS: ± 1/64		
2-PLACE ± .010	ANGLES: ± 3°		
3-PLACE ± .005			
MATERIAL: _____			
FINISH: _____			
DRAWN	DATE	CHECKED	DATE
P.J.P.	1-23-09	J.A.B.	1-23-09
APPROVED	DATE	SHEET	OF
A.T.	1-23-09	1	1

EZ FORM
CABLE CORPORATION
HAMDEN, CT 06517

TITLE
SMP RIGHT ANGLE JACK
FOR .086 DIA.
SEMI RIGID CABLE

A	CODE IDENT.	701400-186	REV.
	9W826		B