

INTERFACE CONFORMS TO MIL-PRF-39012 SMA SERIES

NOTES:

MATERIALS:

- BODY, COUPLING NUT _____ STAINLESS STL. TYPE 303 PER ASTM-A-582
- SNAP RING _____ BERYLLIUM COPPER PER ASTM-B-196
- GASKET _____ SILICONE PER ZZ-R-765
- INSULATOR _____ TEFLON VIRGIN WHITE PER ASTM-D-1710

FINISHES:

- BODY, CONTACT _____ GOLD PLATE PER MIL-G-45204
- COUPLING NUT _____ PASSIVATE PER QQ-P-35

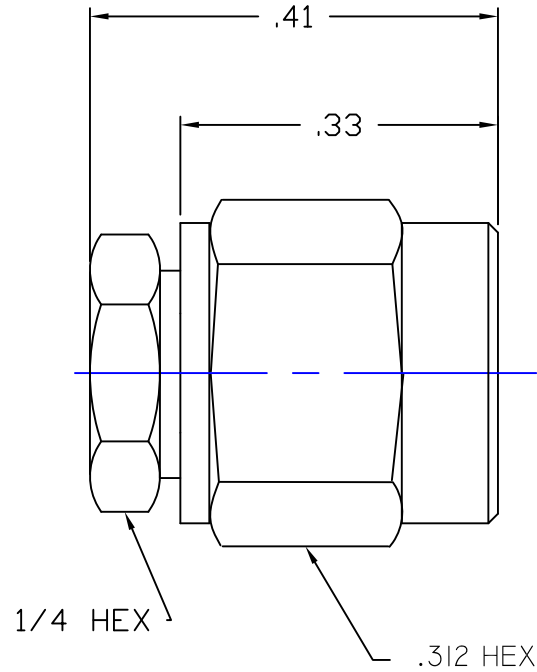
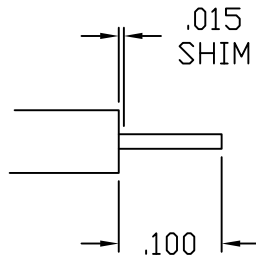

THIS DRAWING THE DESIGNS AND IDEAS EMBEDDED IN THE DEVICE TO WHICH IT RELATES AND THE METHOD OF PRODUCING THE DEVICE SHALL NOT BE EMPLOYED COPIED OR DISCLOSED TO ANYONE IN ANY MANNER WITHOUT THE CONSENT OF AN EZ FORM COMPANY OFFICIAL

APPD		
BY		
DATE		
DESCRIPTION		
REV.		

UNLESS OTHERWISE SPECIFIED:

DIMENSIONS ARE IN INCHES:
TOLERANCES:

DECIMALS:	FRACTIONS	± 1/64
2-PLACE ± .015	ANGLES	± 3
3-PLACE ± .005		

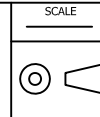

MATERIAL: SEE NOTES			
FINISH: SEE NOTES			
DRAWN	DATE	CHECKED	DATE
P.J.P.	3-7-05	A.T.	3-7-05
APPROVED	DATE	SHEET	OF
J.A.B.	3-7-05		

EZ FORM
CABLE CORPORATION
HAMDEN, CT 06517

TITLE			
SMA MALE PLUG ANTI TORQUE FOR USE WITH .086 SEMI RIGID CABLE			
A	CODE IDENT.		REV.
	9W826	CD-705522-302	