

INTERFACE CONFORMS TO MIL-PRF-39012 SMA SERIES

NOTES:

MATERIALS:

- BODY, COUPLING NUT ————— STAINLESS STL. TYPE 303 PER ASTM-A-582
- SNAP RING ————— BERYLLIUM COPPER PER ASTM-B-196
- GASKET ————— SILICONE PER ZZ-R-765
- INSULATOR ————— TEFLON VIRGIN WHITE PER ASTM-D-1710

FINISHES:

- BODY, CONTACT ————— GOLD PLATE PER MIL-G-45204
- COUPLING NUT ————— PASSIVATE PER QQ-P-35

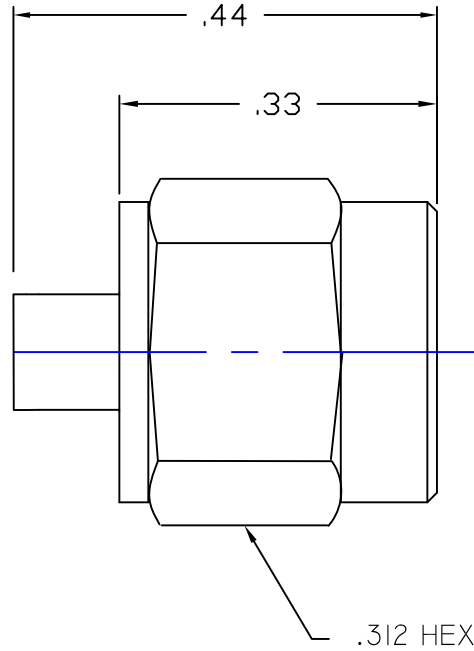
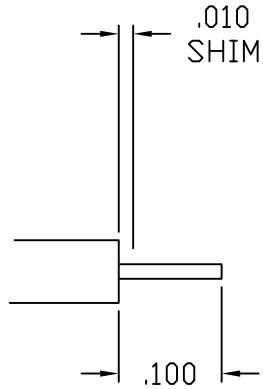

THIS DRAWING THE DESIGNS AND IDEAS EMBEDDED IN THE DEVICE TO WHICH IT RELATES AND THE METHOD OF PRODUCING THE DEVICE SHALL NOT BE EMPLOYED COPIED OR DISCLOSED TO ANYONE IN ANY MANNER WITHOUT THE CONSENT OF AN EZ FORM COMPANY OFFICIAL

APPD	A.T.	
BY	P.J.P.	
DATE	2-6-06	
DESCRIPTION	.010 SHIM WAS .015 SHIM	
REV.	A	

UNLESS OTHERWISE SPECIFIED:

DIMENSIONS ARE IN INCHES:  
TOLERANCES:

DECIMALS:	FRACTIONS	± 1/64
2-PLACE ± .015	ANGLES	± 3
3-PLACE ± .005		

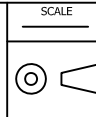

MATERIAL: SEE NOTES

FINISH: SEE NOTES

DRAWN	DATE	CHECKED	DATE
P.J.P.	9-10-03	T.A.R.	9-10-03

APPROVED	DATE	SHEET	OF
J.A.B.	9-10-03		

**EZ FORM**  
**CABLE CORPORATION**  
**HAMDEN, CT 06517**

TITLE  
SMA MALE PLUG SOLDER ON CONTACT  
THICK WALL DESIGN FOR USE WITH .086  
SEMI RIGID CABLE

A	CODE IDENT.	CD-705522-304	REV.	A
	9W826			