

RoHS
COMPLIANT

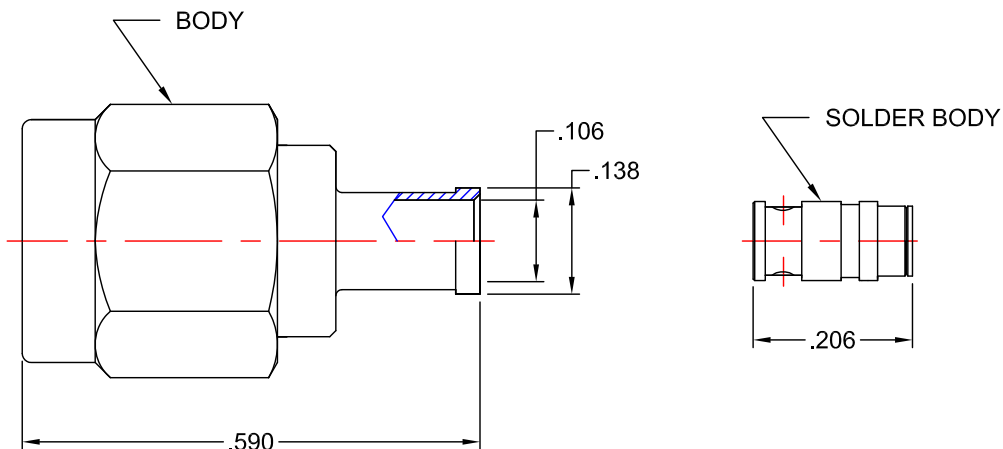

NOTES:

INTERFACE CONFORMS TO MIL-PRF-39012
AND MIL-STD-348 SMA SERIES

ELECTRICAL:

NOMINAL IMPEDANCE: 50Ω
FREQUENCY RANGE: DC TO 12 GHz

MATERIALS:

INSULATOR: TEFLON PER ASTM-D-1710
BODY, CONTACT, & COUPLING NUT: 360 ALLOY BRASS 1/2 HARD PER ASTM-B-16
GASKET: SILCONE RUBBER PER ZZ-R-765
RETAINING RING: BERYLLIUM COPPER PER ASTM-B-196

FINISHES:

CONTACT: GOLD PLATE PER MIL-DTL-45204
BODY & COUPLING NUT: GOLD PLATE PER MIL-DTL-45204

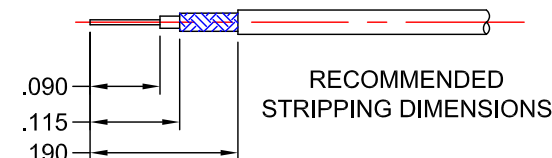
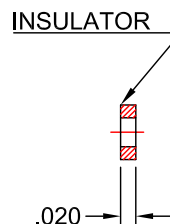
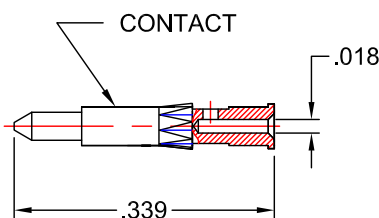

PROPRIETARY NOTICE
 THIS DRAWING AND DESIGNS AND IDEAS EMBEDDED
 IN THE DEVICE TO WHICH IT RELATES AND THE
 METHOD OF PRODUCING THE DEVICE SHALL NOT BE
 EMPLOYED COPIED OR DISCLOSED TO ANYONE IN ANY
 MANNER WITHOUT THE WRITTEN CONSENT OF AN
 EZ FORM COMPANY OFFICIAL

APPD.	T.D.	
DATE	3/20/17	
BY	J.N.	
DATE	3/20/17	
DESCRIPTION	INITIAL RELEASE	
REV.	-	

UNLESS OTHERWISE SPECIFIED:			
DIMENSIONS ARE IN INCHES:		SCALE	
TOLERANCES: NONE		4:1	
MATERIAL: SEE NOTES			
FINISH: SEE NOTES			
DRAWN	DATE	CHECKED	DATE
J.N.	3/20/17	T.D.	3/20/17
APPROVED	DATE	SHEET 1 OF 1	
A.T.	3/20/17		

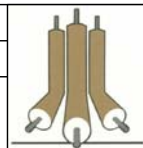

**EZ Form Cable
Corporation**
285 Welton Street
Hamden, CT 06517
WWW.ezform.com

TITLE			
SMA STRAIGHT PLUG FOR RG-178 CABLE			
A	CODE IDENT.	705551-001SMA	REV.
	9W826		-